



KTV-10

**STEAM TRAP TEST VALVE****GENERAL FEATURES****Operating Conditions:**

The trap test valve is generally placed either after the steam trap or two valves are used on both the inlet and outlet of the trap. If the valve is only required for trap testing and no bleed upstream or isolation is required, then only one test valve would be used on the discharge side of the trap. If the design is such that both upstream and downstream isolation with bleed and test capability is needed, then two valves

**Nominal Pressure (PN)** : 40 bar**Max. Oper. Temp. (TMO)** : -50/+230°C**PRODUCT FEATURES****Body Material** : Stainless Steel AISI 304**Ball Material** : Stainless Steel AISI 304**Body Gasket** : PTFE**Ball Seat** : R-PTFE (15%)**Connection Type** : Threaded, Flanged

# KTV-10 STEAM TRAP TEST VALVE

## CONSTRUCTION

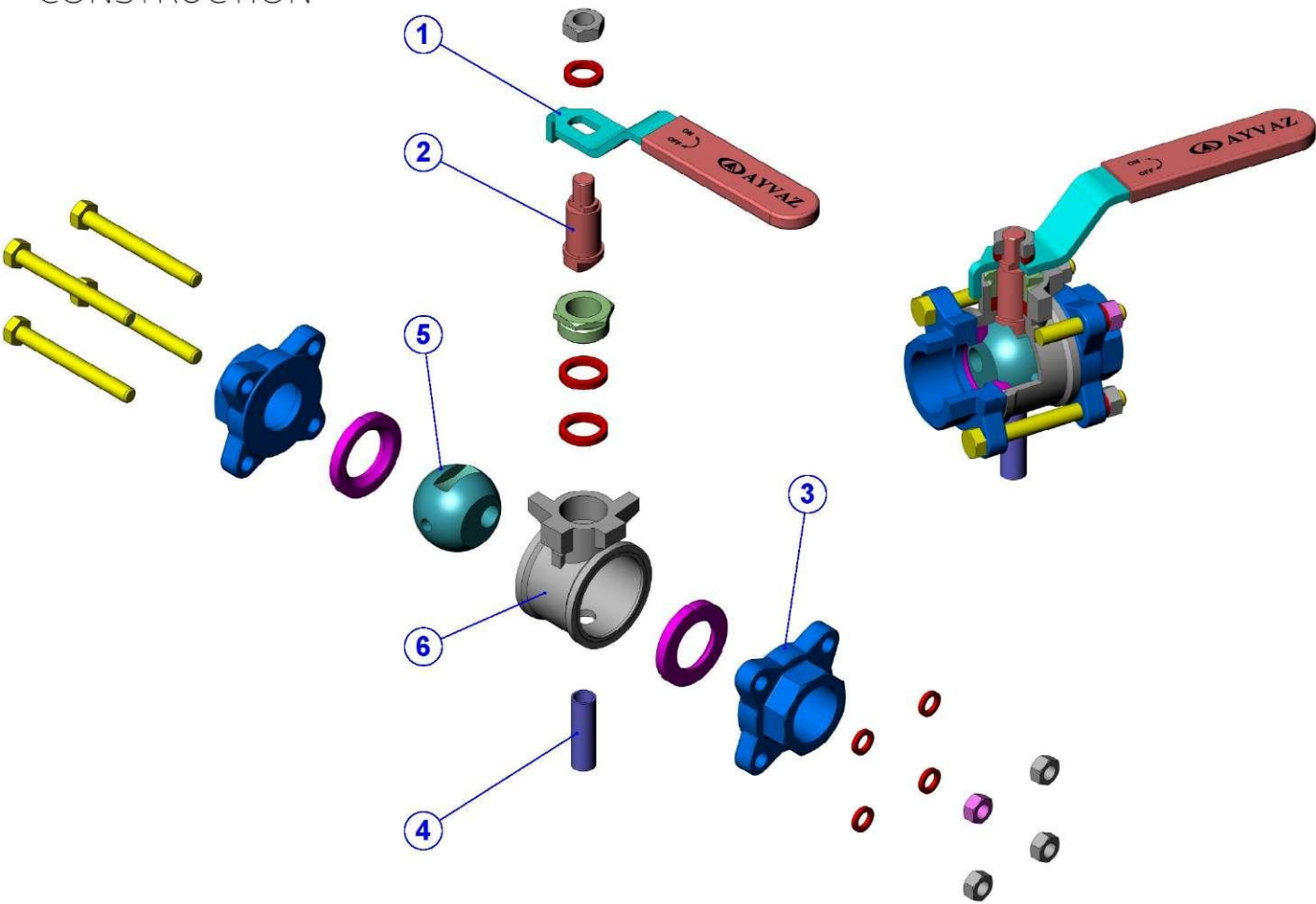

PART LIST		
No	PART NAME	MATERIAL
1	Valve Lever	Carbon Steel
2	Stem	Stainless Steel AISI 304
3	Pipe Connection Part	Stainless Steel AISI 304
4	Pipe	Stainless Steel AISI 304
5	Ball	Stainless Steel AISI 304
6	Valve Body	Stainless Steel AISI 304

# KTV-10 STEAM TRAP TEST VALVE

## THREADED TECHNICAL DRAWING

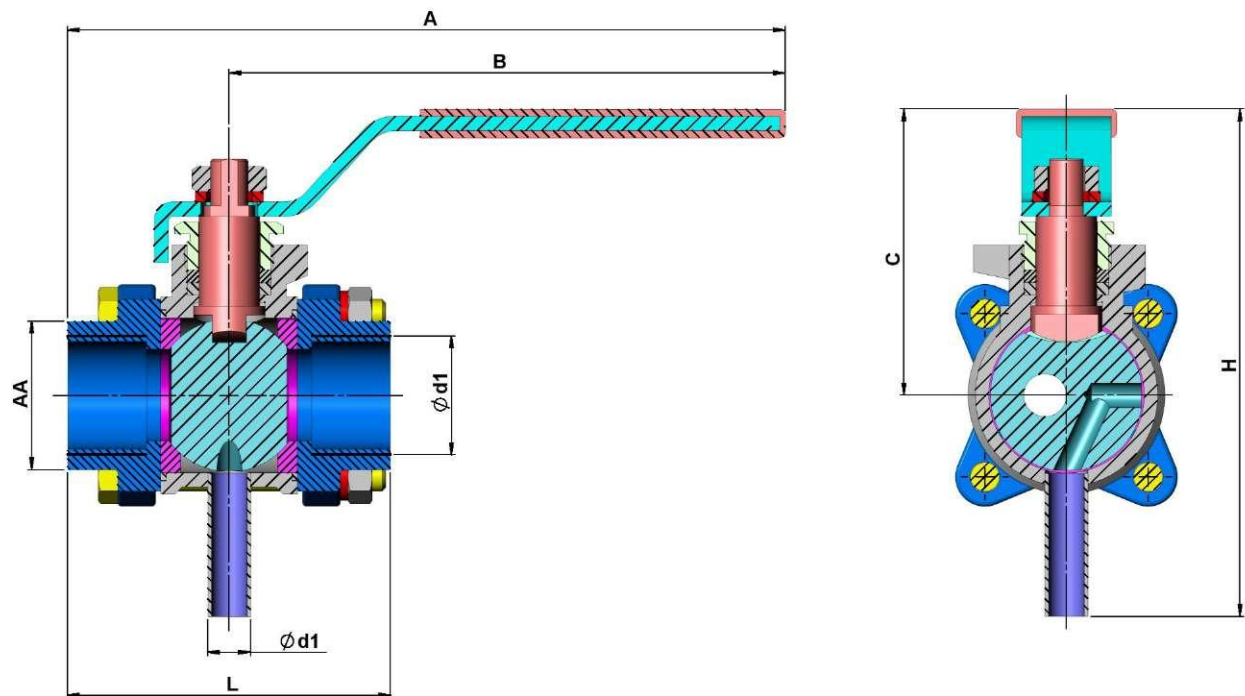

SIZE	THREADED						
	A	B	C	H	Ød1	L	AA
1/2"	155	118	56	111	12	73,5	27
3/4"	159	118	61	120	12	81	35
1"	201	118	80	142	12	90	41,5
1 1/4"	217	166	80	146	20	102,5	51
1 1/2"	251	191	88,5	160	20	120	58
2"	259	191	88,5	176	20	137,5	71

## FLANGED TECHNICAL DRAWING

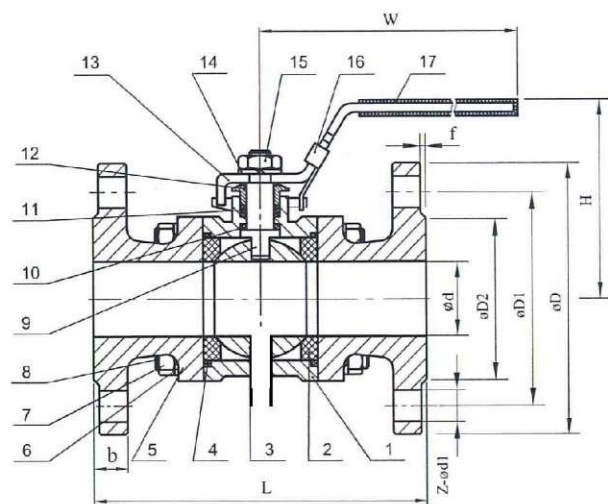

DIMENSIONS											
Size	D	D1	D2	L	H	W	z-Ø d1	f	b	N.m	kg
DN15	1/2"	95	65	45	130	84	4-Ø 14	2	16	5	1,9
DN20	3/4"	105	75	58	150	87	4-Ø 14	2	18	8	2,8
DN25	1"	115	85	68	160	93	4-Ø 14	2	18	10	3,6
DN32	1-1/4"	140	100	78	180	99	4-Ø 18	2	18	14	5,4
DN40	1-1/2"	150	110	88	200	114	4-Ø 18	3	18	18	6,3
DN50	2"	165	125	102	230	122	4-Ø 18	3	20	25	8,5

## KTV-10 STEAM TRAP TEST VALVE

### 3D APPLICATION

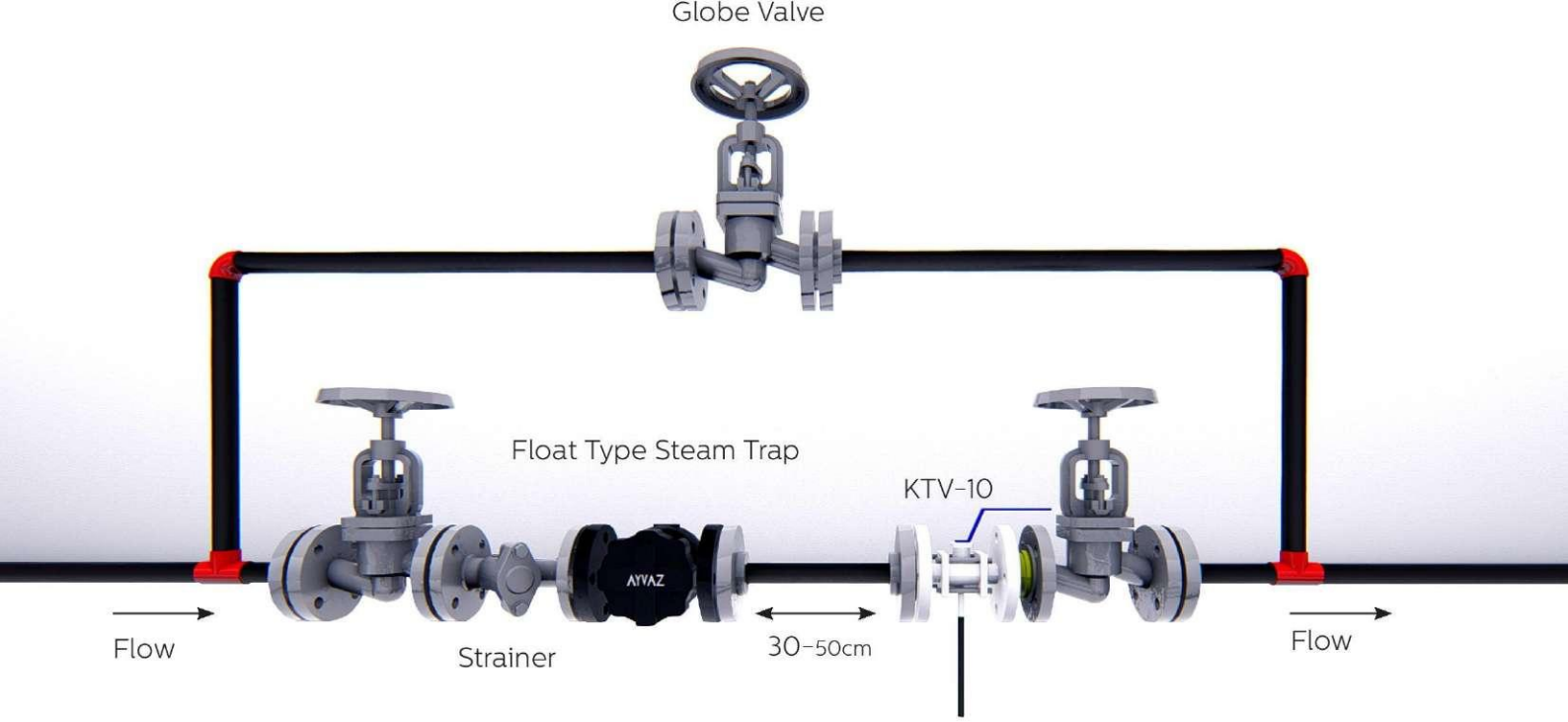

The condensate test valve must be assembled at least 30-50 cm after the steam trap. If it is done immediately after the steam trap, it can detect the steam that is generated when the test valve is opened and as a vapor leak.

When the test valve is installed after 30-50 cm, the flash steam is condensed to this point and condensed into condensate. This means that the test valve can be used to determine if there is a leak in the steam trap. If the installation of the valve is similar to the image, the fluid continues through the test valve and continues in the flow direction. If the handle of the valve is brought to the closed position, the fluid is discharged perpendicular to the flow direction.



#### HEAD OFFICE - FACTORY

Atatürk Sanayi Bölgesi Hadımköy Mahallesi Mustafa İnan Caddesi No: 44 Arnavutköy - İSTANBUL  
Tel: +90 212 771 01 45 (pbx) | Fax: +90 212 771 47 27  
info@ayvaz.com | www.ayvaz.com