

# SK-80

## FLOAT TYPE STEAM TRAP

### GENERAL FEATURES

SK 80 Float Steam Trap is used for discharging the condensate by a mechanical float system. When the system starts up, thermostatic air vent is activated and discharges the air in the system. After this process, incoming steam will close the air vent. However when condensate reaches the steam trap, the float rises and opens the main valve and discharges the condensate. As soon as the condensate discharge is completed and the steam reached into the trap, the float goes down and closes the valve.

#### Installation:

SK-80 can be installed horizontally from right to the left or opposite way. If it is not indicated differently in the order sheet, it will be assumed.

#### Product Features:

**Body:** Ductile Iron GGG 40.3

**Cover:** Ductile Iron GGG 40.3

**Internals and float:**

Stainless Steel AISI 304

**Connection:** Flanged

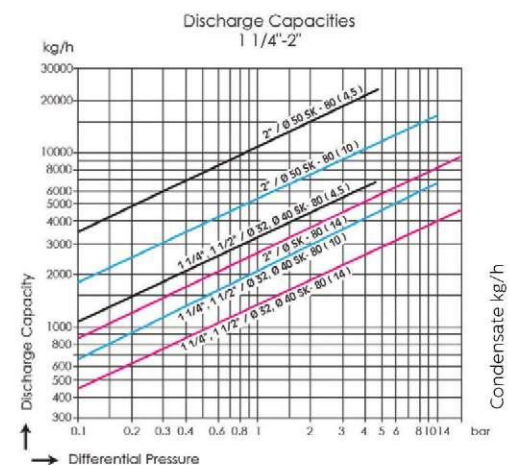
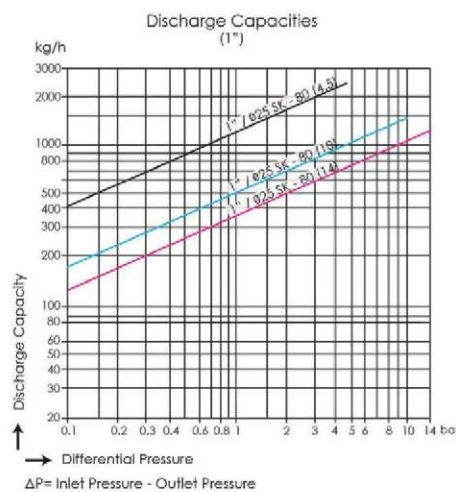

#### Discharge Chart:

**Red Chart** :  $\Delta p = 14$  bar

**Blue Chart** :  $\Delta p = 10$  bar

**Black Chart** :  $\Delta p = 4.5$  bar

OPERATING CONDITIONS	
Max. Operating Pressure	16 bar
Max. Differential Pressure ( $\Delta P$ )	4.5-10-14 bar
Max. Operating Temperature	250 °C



\* Please ask to our sales team for different pressures and diameters.

## SK-80 FLOAT TYPE STEAM TRAP

### DN25 TECHNICAL SPECIFICATIONS

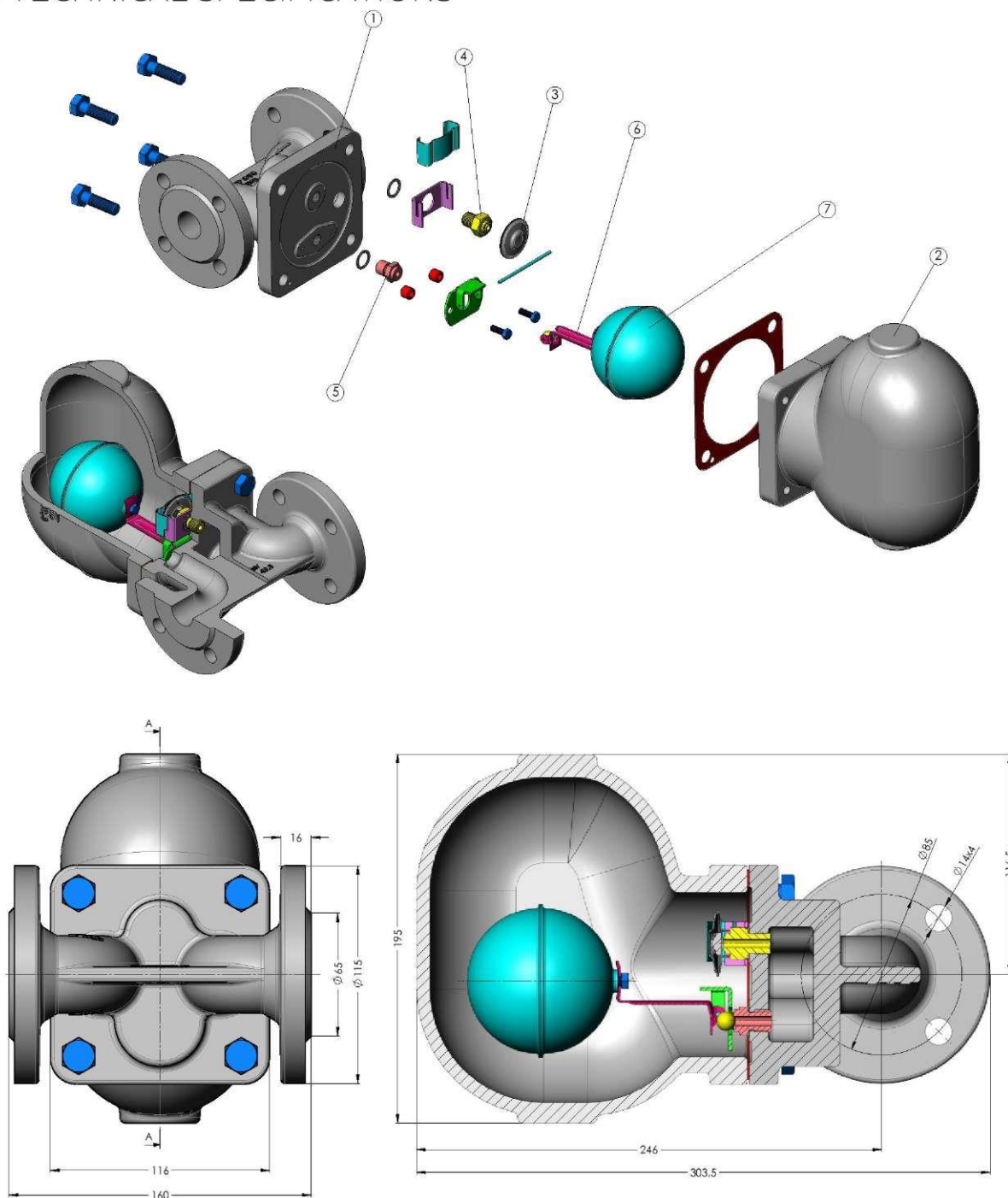

SPARE PARTS		
No	Part Name	Material
1	Body	GGG 40.3
2	Cover	GGG 40.3
3	Thermostatic Capsule	Stainless Steel
4	Capsule Seat	AISI 304 Stainless Steel
5	Float Seat	AISI 304 Stainless Steel
6	Float Lever	AISI 304 Stainless Steel
7	Float	AISI 304 Stainless Steel

All dimensions are given in mm.

## SK-80 FLOAT TYPE STEAM TRAP

### DN32-40-50 TTECHNICAL SPECIFICATIONS

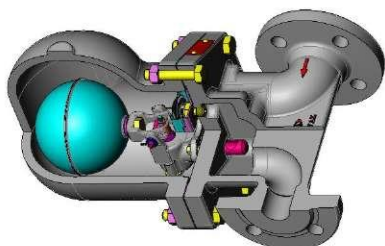
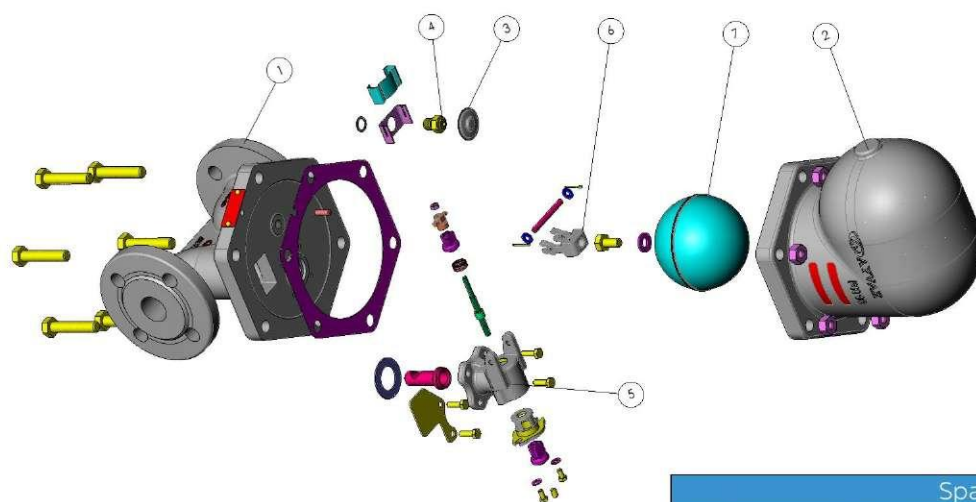

Spare Parts		
No	Part Name	Materials
1	Body	GGG 40.3
2	Cover	GGG 40.3
3	Thermostatic Capsule	Stainless Steel
4	Capsule Seat	AISI 304 Stainless Steel
5	Valve	Stainless Steel
6	Float Lever	AISI 304 Stainless Steel
7	Float	AISI 304 Stainless Steel

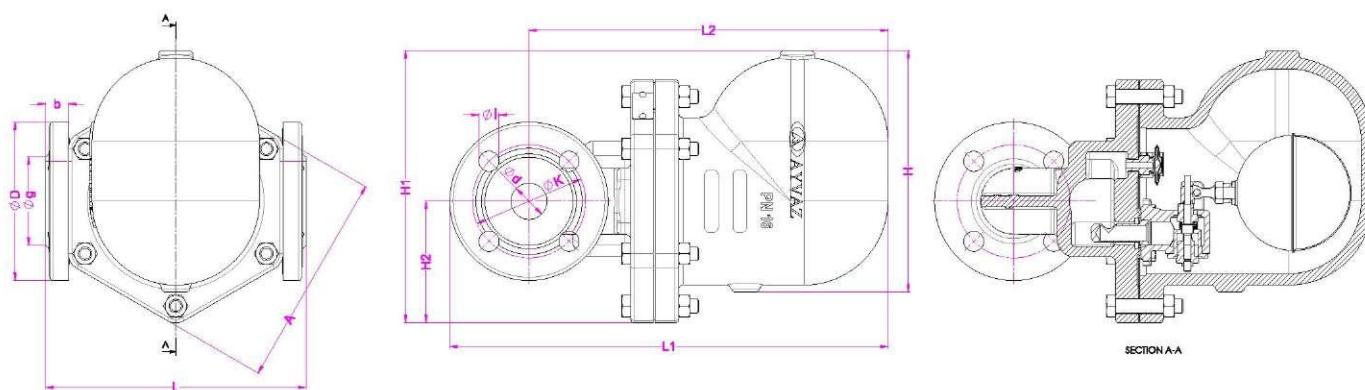

Dia.	ØD	Øk	Øg	Øb	Ø lxn	A	H1	H2	H	L1	L2	L
32	140	100	78	20	18x4	190	241	108	213	388	318	230
40	150	110	88	20	18x4	190	241	108	213	393	318	230
50	165	125	102	22	18x4	220	262	124	230	417	335	230

All dimensions are given in mm.

## **SK-80** FLOAT TYPE STEAM TRAP

---

## **SK-80 FLOAT TYPE STEAM TRAP**

