



CV10/S1-S2

CHECK VALVES

GENERAL FEATURES

Check valves are commonly used armatures that can be applied for liquid, gaseous and steam applications. They increase the process safety and can be used instead of complicated armatures. Because of short installation time and installation distance, small dimensions; Ayvaz disco check valve appears to be advantageous.

Check valves provide the **flows** just one way. When liquid **flows** through to **flowing** direction, check valves open and let it pass. But liquid tries to **flow** opposite direction of **flowing**, check valves close and prevent passing.

Connection:

Wafer type

Nominal Diameter:

DN15 (1/2") - DN100 (4")

Working Pressure: Up to 40 bars

Typical Applications:

- Iron and steel industry
- Heating air-conditioning pipe lines
- Mineral, oil industry
- Wood working, pulp and paper industry
- Textile industry
- Water and condensate lines
- Nautical industry

SEATS		VALVES	
		CV10/S1	CV10/S2
METAL	max	300 °C	300 °C
	min	-60 °C	-60 °C
NBR	max	120 °C	120 °C
	min	-30 °C	-30 °C
EPDM	max	150 °C	150 °C
	min	-40 °C	-40 °C
FKM	max	200 °C	200 °C
	min	-25 °C	-25 °C
PTFE	max	230-250 °C	230-250 °C
	min	-60 °C	-60 °C

SIZES	
mm	inches
15-100	1/2" - 4"

WEIGHTS									
Connection Type	Flanged								
Sizes (mm)	15	20	25	32	40	50	65	80	100
Weights (kg)	0,08	0.13	0.18	0.33	0.54	0.89	1.2	2.1	3.1

OPERATING CONDITIONS	
Nominal Pressure PN	40
Max. Operating Pressure (bar)	40-38-37
Temp. Related to Pressure (°C)	100-200-300

CONNECTIONS	
Wafer Type	BS 10 tables D, E, F DIN 2501 (PN 6/10/16) ANSI B 16.1 class 125 FF

CV10/S1-S2 CHECK VALVES

The curves given in the chart are valid for water at 20°C. To read the pressure drop for other fluids the equivalent water volume flow rate must be calculated and used in the graph.

The values indicated in the chart are applicable to spring - loaded valves with horizontal flow.

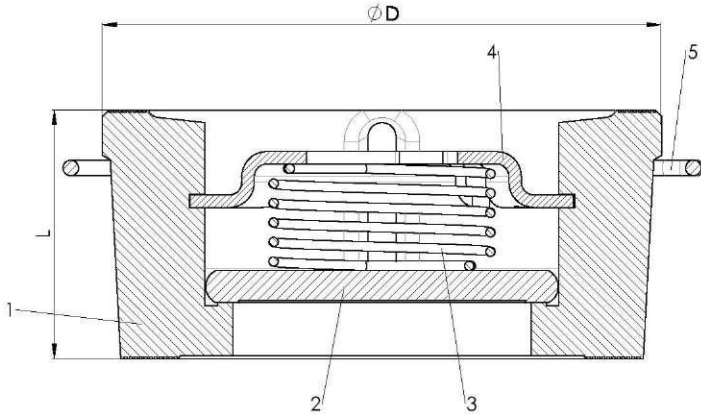

SPARE PARTS		CV 10/S1	CV 10/S2
1	Body	AISI 304 Stainless Steel	AISI 316 Stainless Steel
2	Disc	AISI 304 Stainless Steel	AISI 316 Stainless Steel
3	Spring	AISI 304 Stainless Steel	AISI 316 Stainless Steel
4	Segment	AISI 304 Stainless Steel	AISI 316 Stainless Steel
5	Centering Hoop	AISI 304 Stainless Steel	AISI 316 Stainless Steel

DIMENSIONS										
Diameter mm	15	20	25	32	40	50	65	80	100	
L (mm)	16	19	21	27	31	40	46	50	60	
D (mm)	39	46	54	70	80	96	113	130	150	

OPENING PRESSURE MBAR					
DN	Flow Direction				
	Without Spring ↑	Spring			↓
		↑	⇒	↓	
15	2.5	25	22.5	20	
20	2.5	25	22.5	20	
25	2.5	25	22.5	20	
32	3.5	27	23.5	20	
40	4	28	24	20	
50	4.5	29	24.5	20	
65	5	30	25	20	
80	5.5	31	25.5	20	
100	6.5	33	26.5	20	

Pressure Drop Chart

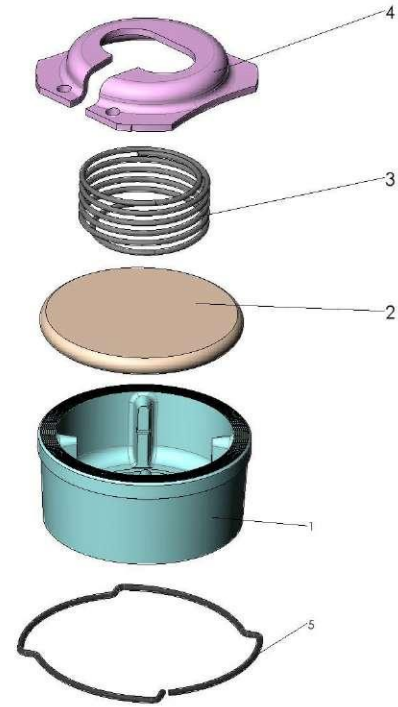
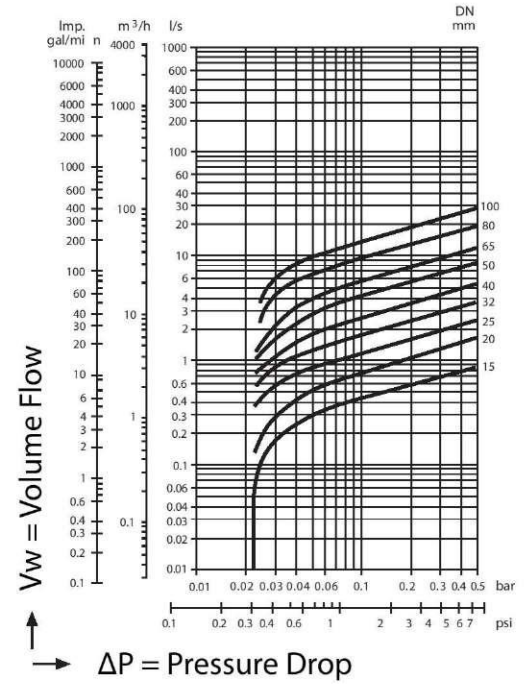

HEAD OFFICE - FACTORY

Atatürk Sanayi Bölgesi Hadımköy Mahallesi Mustafa İnan Caddesi No: 44 Arnavutköy - İSTANBUL
 Tel: +90 212 771 01 45 (pbx) | Fax: +90 212 771 47 27
 info@ayvaz.com | www.ayvaz.com